

Xpert[®] Bladder Cancer Cartridge Preparation depicting urine sample

Refer to the package insert for detailed instructions, precautions, and warnings.

For a copy of the SDS, visit www.cepheid.com or www.cepheidinternational.com

Cepheid Technical Support
US office
(888) 838-3222
techsupport@cepheid.com

European office
+33 563 82 53 19
support@cepheideurope.com



- 1 Obtain one appropriately collected and labeled urine sample.

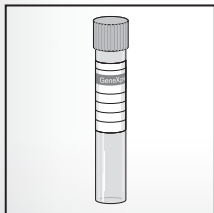

- 2 Obtain one Xpert Bladder Cancer cartridge and transfer pipette (provided).



- 3 Open the Xpert cartridge lid.



- 4 Gently invert the transport tube 3 times to mix.

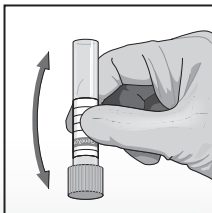

- 5 Fill the transfer pipette with sample up to the 4 mL mark.

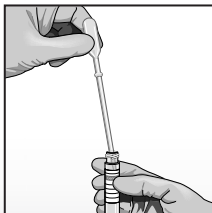

- 6 Empty the pipette contents into the sample chamber.



- 7 Close the Xpert cartridge lid.



- 8 Insert the cartridge and start the assay.

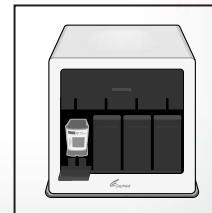

Xpert® Bladder Cancer Cartridge Preparation depicting urine sample in primary sample cup

Refer to the package insert for detailed instructions, precautions, and warnings.

For a copy of the SDS, visit www.cepheid.com or www.cepheidinternational.com

Cepheid Technical Support
US office
(888) 838-3222
techsupport@cepheid.com

European office
+33 563 82 53 19
support@cepheideurope.com



- 1 Obtain a urine sample of at least 4.5mL in the primary collection cup.
- 2 Obtain one Xpert Urine Transport Reagent kit.
- 3 Invert cup 3 times to mix the urine.
- 4 Use the disposable transfer pipette provided in the Xpert Urine Transport Reagent kit in the pouch with the tube. NOTE: Do not use the pipette from the assay kit.
- 5 Insert the transfer pipette into the bottom of the urine cup.
- 6 Transfer approximately 4.5 mL of urine so that the volume reaches the black line on the tube label.
- 7 Replace the cap on the Xpert Urine Transport Reagent tube and tighten securely. Label correctly and transfer to the GeneXpert cartridge preparation area.
- 8 See reverse side of this card for further instructions.

