

Xpert® Xpress GBS Cartridge Preparation

Refer to the package insert for detailed instructions, precautions, and warnings.

For a copy of the SDS, visit www.cepheid.com or www.cepheidinternational.com

Cepheid Technical Support
US office
(888) 838-3222
techsupport@cepheid.com

European office
+33 563 82 53 19
support@cepheideurope.com



1 Obtain one cartridge.



2 Open the cartridge lid.

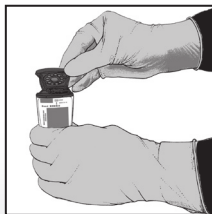

3 Remove one swab from cap and gently brush the two swabs together using a twirling motion for five seconds. Return the second swab still attached to the cap back into the transport tube.

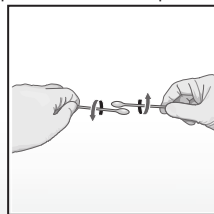

Note: Do not hold the swab below the score mark

4 Insert the swab into the cartridge sample chamber. Break the swab at the score mark.

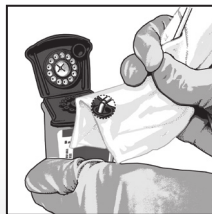

Note: Use gauze or its equivalent to minimize the risk of contamination.

5 Make sure the swab can float freely in the chamber.



Incorrect swab placement. Swab end is caught in the notch of the sample chamber opening.



6 Close the cartridge lid. Start the test within the timeframe specified in the package insert.



Xpert Retest Procedure

• Xpert® Xpress GBS

Refer to the package insert for detailed instructions, precautions, and warnings.

For a copy of the SDS, visit www.cepheid.com or www.cepheidinternational.com

Cepheid Technical Support
US office
(888) 838-3222, Option 2
techsupport@cepheid.com

European office
+33 563 82 53 19
support@cepheideurope.com



1 Discard used cartridge. Obtain a new Xpert® Xpress GBS cartridge. Remove the remaining swab from the collection transport tube.



2 Insert swab into the sample chamber of the new cartridge. Raise the swab so that the score mark is centered in the notch. Break the swab by snapping to the right.



3 Ensure the swab is properly positioned in the cartridge and the swab end is not in the notch of the sample chamber opening and does not prevent lid closure.

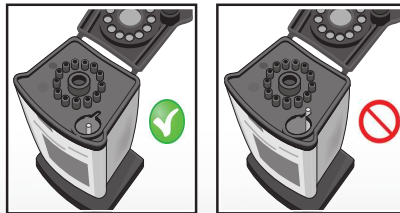

4 If the swab is stuck in the notch, use a lint free wipe/gauze or the remaining end of the swab to release it from the notch to minimize the risk of contamination.



5 Close the cartridge lid. Start the test within the timeframe specified in the package insert.

