

Xpert® HPV v2 Cartridge Preparation

Refer to the Instructions for Use for detailed instructions, precautions, and warnings.

1

Obtain one appropriately collected and labeled test sample.

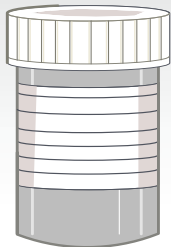

2

Obtain one Xpert HPV v2 cartridge and transfer pipette (provided). The line on the pipette indicates 1mL fill volume. Label the cartridge with sample identification.



3

Inspect the test cartridge for damage. If damaged, do not use it. Open the cartridge lid.

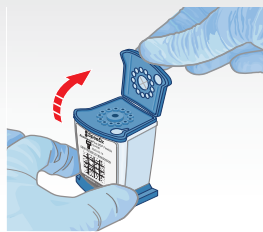

4

Mix the sample by gently inverting the sample vial 8 to 10 times, or by vortexing briefly with a vortex mixer at half-speed continuously for 5 seconds.



5

Unwrap the transfer pipette. Open the sample vial lid, compress the transfer pipette bulb, insert the pipette into the vial, and release the bulb to fill the transfer pipette to the 1 mL line. Ensure the pipette is filled, with no bubbles present.



6

Expel the pipette's contents into the sample chamber of the cartridge. Avoid adding excess mucus to the cartridge.

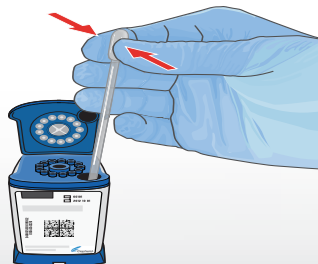

7

Close the cartridge lid and start the test within the timeframe specified in the IFU.

